

# 24' X 36' MAN CAMP CUBE

XTREME CUBE



**Portable home away from home**

The 24' x 36' Man Camp features four bedrooms with attached baths, full laundry and kitchen, plus a living room.

**XTREME CUBES™**  
BY XTREME CUBES CORPORATION 

# 24' X 36' MAN CAMP CUBE

Contact Us  
T: 800-497-1704  
E: [cuberfq@xmfg.com](mailto:cuberfq@xmfg.com)

## STANDARD FEATURES

- Factory customized housing built for temporary or permanent use
- Ideal for mining, oil, forestry, construction sites, disaster relief, government and military needs
- Unlimited floor plan configurations
- Amenities designed for comfort, including complete bathrooms
- Fully transportable yet durable for long term
- Complete with appliances, lavatories, showers and laundry
- Premium finishes

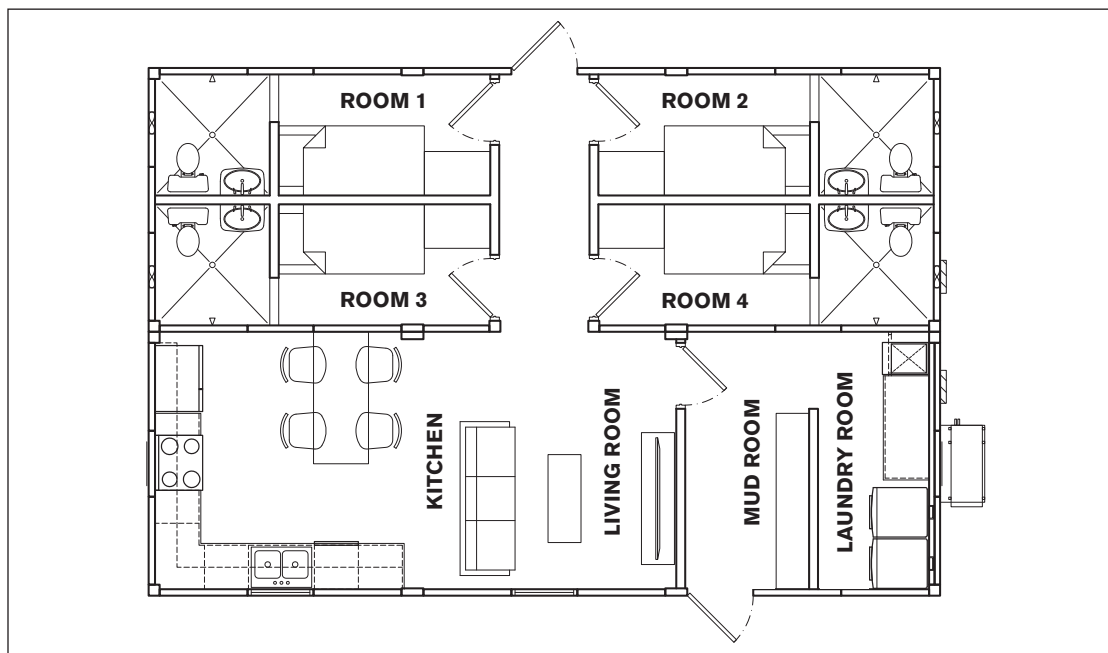

## ABOUT XTREME CUBES

- Welded structural steel tube frame enhances the Cube's overall strength and increases options for customization.
- The standard Cube height is 10'. Cube lengths and widths are available in increments of 8', 10' and 12'.
- Modular wall panels can be easily customized with doors, windows, and other options.
- Premium components are utilized inside and out for durability and long life.
- Each Cube is engineered to your specific location conditions to withstand snow load, wind load and seismic events.
- Utility connections are preconfigured for a convenient and simple installation.
- Installation is quick and simple. When delivered, Cubes can be set in position, connected to site utilities and ready to use immediately.

**XTREME CUBES**<sup>™</sup>

[www.xtremecubescorp.com](http://www.xtremecubescorp.com)